

STATE OF NORTH CAROLINA  
DEPARTMENT OF TRANSPORTATION  
HIGHWAY DIVISION 6

# PLANS

**Let Date: October 18, 2023**

**CONTRACT ID: DF00452**

**TIP NO.: -----**

**FEDERAL AID NO.: STATE FUNDED**

**WBS ELEMENT NO.: 2024CPT.06.04.20262.1**

**ROUTE NO.: VARIOUS**

**LOCATION: VARIOUS**

**COUNTY: CUMBERLAND**

**TYPE OF WORK: ASPHALT SURFACE TREATMENT – DOUBLE SEALS**

**LENGTH OF PROJECT: 18.56 MILES**

**This electronic collection of documents is provided  
for the convenience of the user  
and is Not a Certified Document –**

**The documents contained herein were originally issued  
and sealed by the individuals whose names and license  
numbers appear on each page, on the dates appearing  
with their signature on that page.**

**This file or an individual page  
shall not be considered a certified document.**

# Cumberland County AST Contract

WBS: 2024CPT.06.04.20262.1

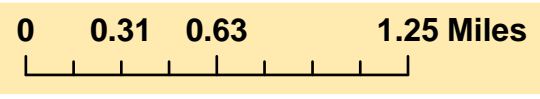
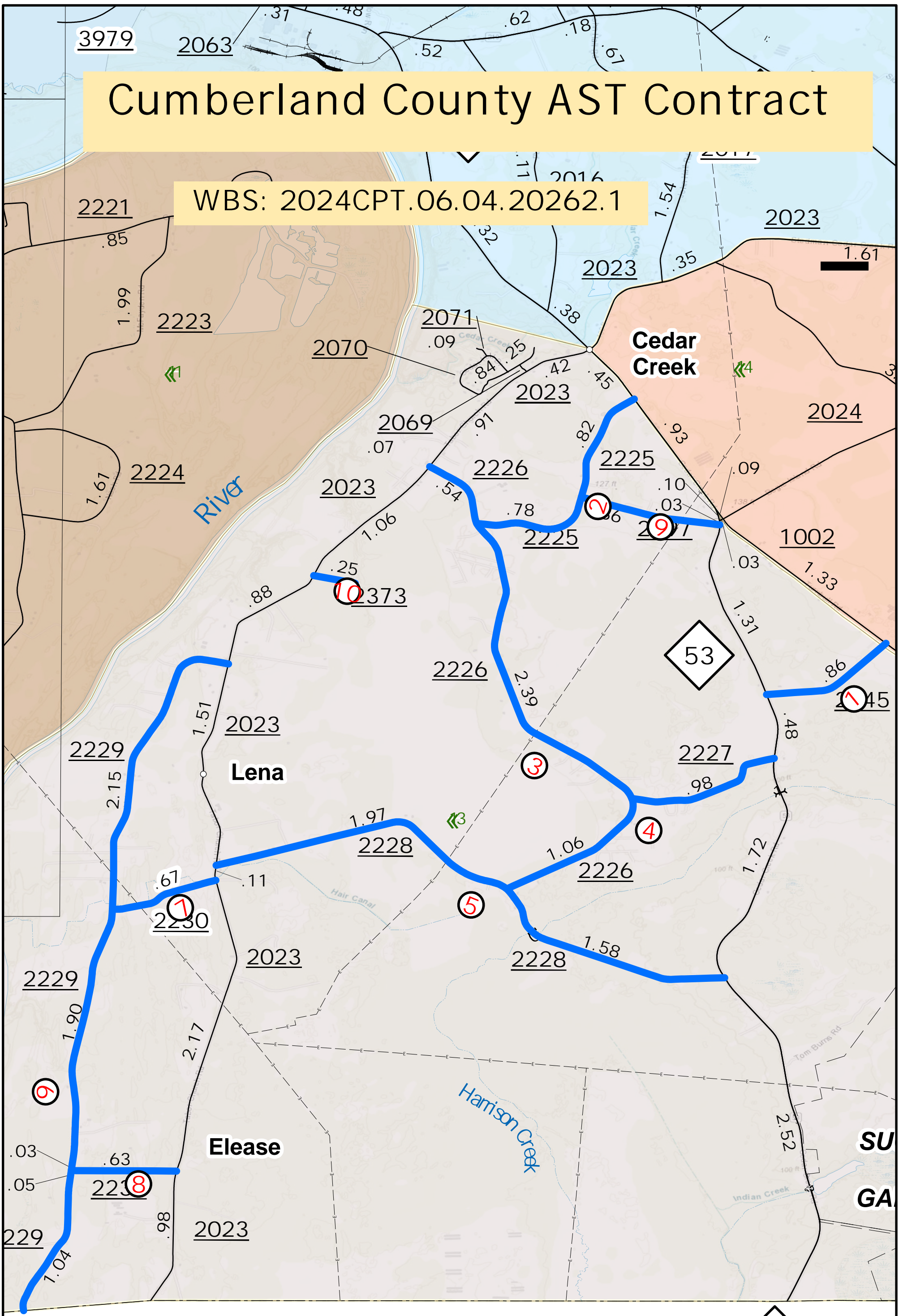

Legend  
Contract DF00452

53  
INCREMENT P, USGS, METI/  
NASA, EPA, USDA

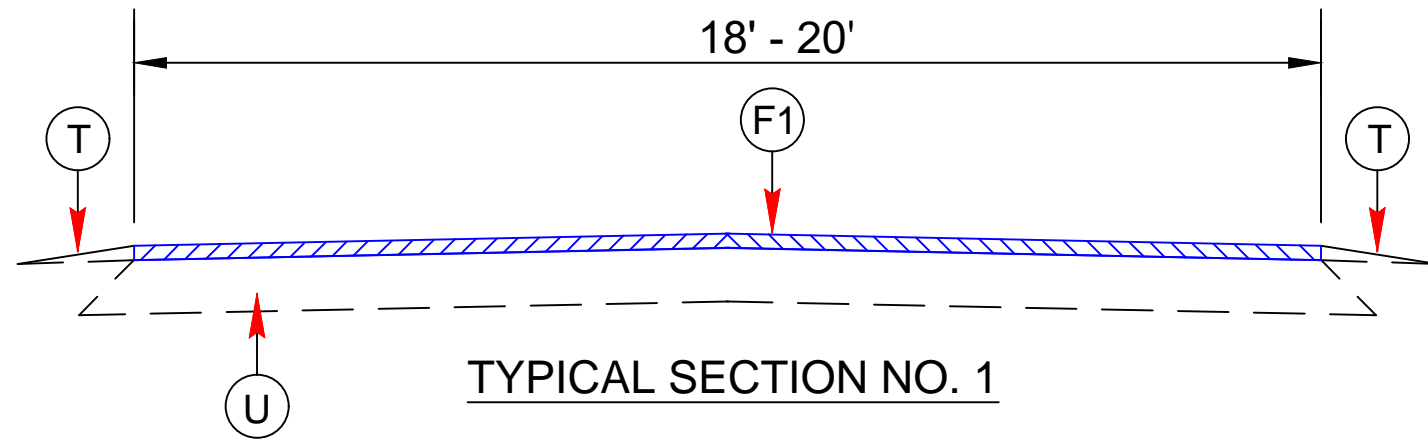

PAVEMENT SCHEDULE	
F1	DOUBLE SEAL PLACED ACCORDING TO THE SPECIAL PROVISIONS
T	EXISTING SHOULDER
U	EXISTING ASPHALT

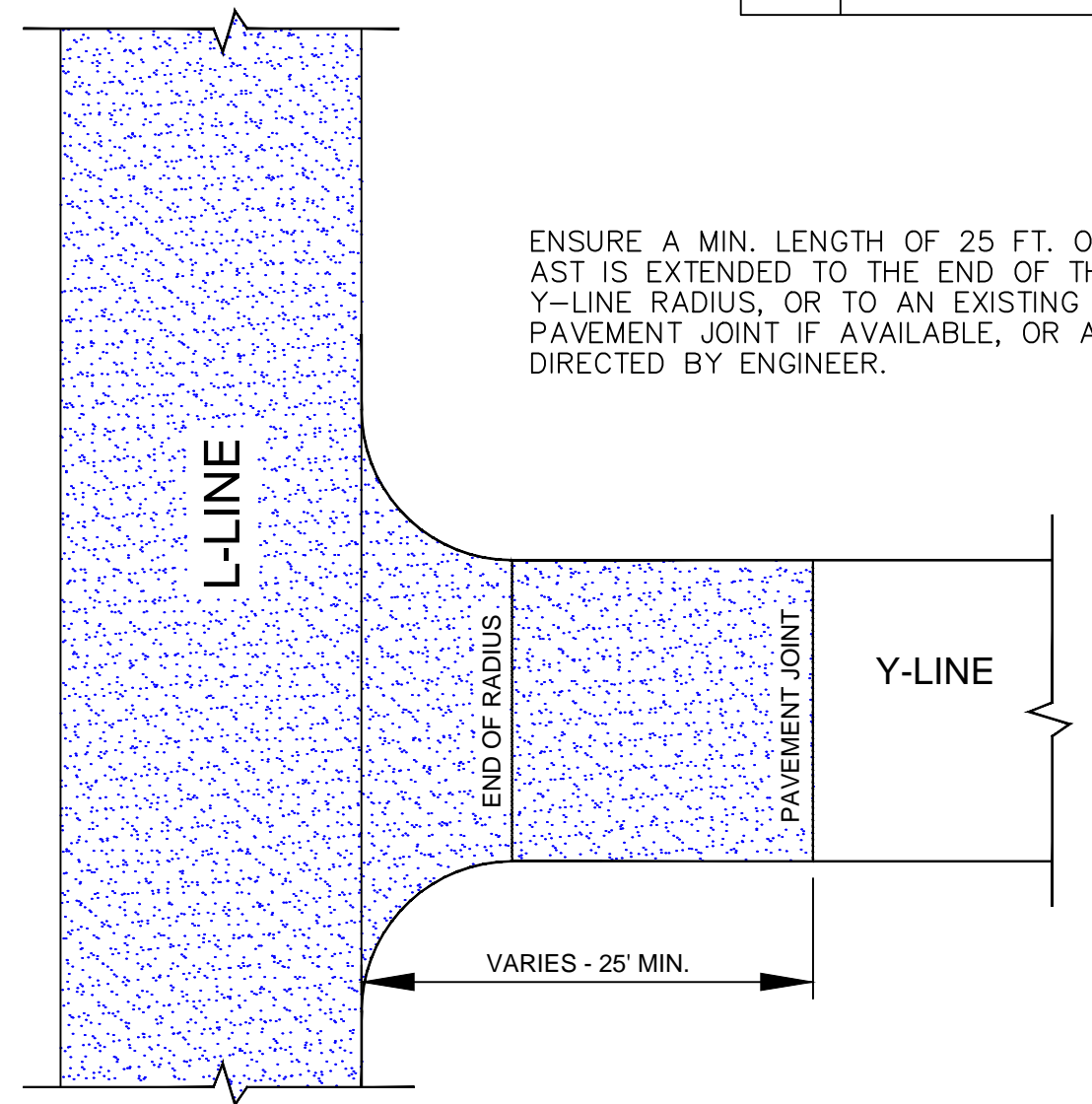

**DETAIL 1**  
Y-LINE INTERSECTION TREATMENT

# SIGNING FOR ASPHALT SURFACE TREATMENT

**LEGEND**

- PORTABLE SIGN
- STATIONARY SIGN
- DIRECTION OF TRAFFIC FLOW

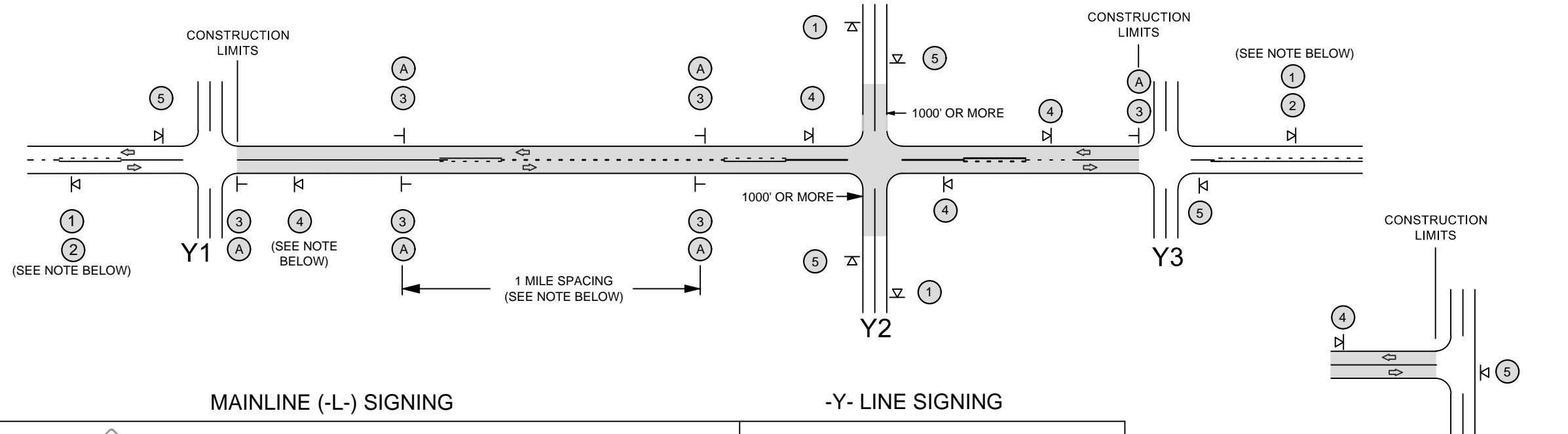

## MAINLINE (-L-) SIGNING

## -Y- LINE SIGNING

SIGNING NOTES AND PLACEMENT PER DIRECTION	<p>① ROAD WORK AHEAD W20-1 48" X 48"</p> <p>② NEXT XX MILES W7-3aP 24" X 18"</p>	<p>- PLACE 1000' PRIOR TO BEGINNING OF CONSTRUCTION LIMITS. ONLY USED ON -Y- LINES IF RESURFACING LIMITS EXTEND 1000' ALONG -Y- LINE.</p> <p>- SIGN #2 ONLY USED WHEN RESURFACING LIMITS ARE 2 OR MORE MILES IN LENGTH. ROUND UP TO THE NEAREST WHOLE NUMBER. DO NOT USE FRACTIONAL OR DECIMAL NUMBERS.</p>	<p>STATIONARY SIGNING NOT REQUIRED FOR THE FOLLOWING -Y- LINE CONDITIONS:</p> <ol style="list-style-type: none"> <li>LESS THAN 1000' OF RESURFACING ALONG -Y- LINE</li> <li>SUBDIVISION ROADS</li> <li>DEAD END ROADS</li> </ol> <p>WHEN PAVING/CONSTRUCTION ACTIVITIES PROCEED ACROSS AN UNSIGNED -Y- LINE, PORTABLE ADVANCE WARNING SIGNS SHALL BE USED ALONG THE -Y- LINE AS SHOWN BELOW. REMOVE UPON COMPLETION OF WORK.</p> <div style="display: flex; justify-content: space-around;"> <div style="text-align: center;"> <p>W20-1 48" X 48"</p> <p>PLACED 500' IN ADVANCE OF FLAGGER.</p> </div> <div style="text-align: center;"> <p>W20-7 A 48" X 48"</p> <p>PLACED 250' IN ADVANCE OF FLAGGER.</p> </div> </div>
	<p>③ LOOSE GRAVEL W8-7 48" X 48"</p> <p>UNMARKED PAVEMENT SP 48" X 48"</p>	<p>- ALTERNATE THE FOLLOWING TWO SIGNS:</p> <p>- STARTING WITH "LOOSE GRAVEL" (W8-7) FOLLOWED BY "UNMARKED PAVEMENT".</p> <p>- PLACE INITIALLY AT THE CONSTRUCTION LIMITS AND SPACED 1 MILE APART THEREAFTER.</p> <p>- AT TEE INTERSECTIONS INSTALL INITIALLY 0.5 MILE FROM INTERSECTION AND SPACE 1 MILE APART THEREAFTER.</p>	
	<p>A SPEED LIMIT 35 W13-1P 18" X 18"</p>	<p>PLACE INITIALLY AT THE CONSTRUCTION LIMITS AND SPACED 1 MILE APART THEREAFTER. IF NO -Y- LINES EXIST, PLACE 2ND SET 1/2 MILE FROM THE CONSTRUCTION LIMITS AND THEN SPACE 1 MILE THEREAFTER. SPEED LIMIT SIGN MAY BE PLACED ON SAME POST AS LOOSE GRAVEL SIGN, IF DESIRED.</p>	
	<p>④ ROAD UNDER CONST SP 13106 48" X 48"</p>	<p>- THESE ARE FOR -Y- LINES THAT ARE "THROUGH" ROADWAYS. DEAD END AND SUBDIVISION ROADS ARE NOT "THROUGH" ROADWAYS.</p> <p>- INSTALL 500' +/- FROM EACH -Y- LINE APPROACH AS SHOWN ABOVE.</p> <p>- FOR MULTIPLE -Y- LINES THAT ARE SEPARATED BY 0.25 MILES OR LESS, TREAT AS A SINGLE UNIT AND INSTALL WITHIN 500' OF EACH APPROACH.</p> <p>- A MAXIMUM OF 2 SIGN SETS PER MILE. DO NOT INSTALL WHEN -Y- LINES ARE WITHIN 0.5 MILES FROM "END ROAD WORK" SIGN.</p>	
	<p>⑤ END ROAD WORK G20-2 A 48" X 24"</p>	<p>PLACE 500' FOLLOWING THE END OF CONSTRUCTION LIMITS OR AS SHOWN WHEN WORK ENDS AT A 3-WAY TEE INTERSECTION.</p>	

**NOTE:**  
IT IS THE CONTRACTOR'S RESPONSIBILITY TO ENSURE THE PROPER PLACEMENT AND LOCATION OF WORK ZONE SIGNING PER THE STANDARD DRAWING. NCDOT HAS THE RIGHT TO INSPECT THE PLANNED LOCATIONS AND REQUIRE ADJUSTMENT BY THE CONTRACTOR, AS NEEDED, OR AS DIRECTED BY THE ENGINEER.

**MAPS LESS THAN 2 MILES**  
FOR AST RESURFACING MAPS WITH CONSTRUCTION LIMITS LESS THAN 2 MILES IN LENGTH, USE A STATIONARY "LOOSE GRAVEL" SIGN AT THE BEGINNING CONSTRUCTION LIMIT FOLLOWED BY AN "UNMARKED PAVEMENT" SIGN MIDWAY THROUGH AND AN "END ROAD WORK" SIGN AT THE END CONSTRUCTION LIMIT.

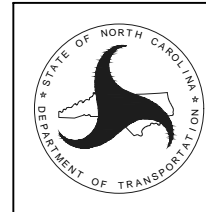

REVISED - 12-13-2018  
NCDOT - DIVISION 6  
ADVANCE WARNING SIGNS FOR 2-LANE ROADWAY ASPHALT SURFACE TREATMENT

PROJECT NO.	SHEET NO.	TOTAL NO.
2024CPT.06.20262.1		

## SUMMARY OF QUANTITIES

PROJECT NO	COUNTY	MAP NO	ROUTE	DESCRIPTION	TYP NO	LANES	LANE TYPE	FINAL SURFACE TESTING REQUIRED	WARM MIX ASPHALT REQUIRED	LENGTH	WIDTH	BEGIN MP	END MP	180350000-E	183800000-E
														ASPHALT SURFACE TREATMENT, DOUBLE SEAL	EMULSION FOR ASPHALT SURFACE TREATMENT
														SY	GAL
2024CPT.06.20262.1	Cumberland	1	SR-2045 / A B SMITH RD	FROM SR 1002 TO NC 53		2	2WU	NO	NO	0.86	20	0	0.86	11,048	6,076
<b>TOTAL FOR MAP NO. 1</b>														<b>11,048</b>	<b>6,076</b>
2024CPT.06.20262.1	Cumberland	2	SR-2373 / MILL CREEK RD	FROM SR 2023 TO DEAD END		2	2WU	NO	NO	0.26	18	0	0.26	2,962	1,629
<b>TOTAL FOR MAP NO. 2</b>														<b>2,962</b>	<b>1,629</b>
2024CPT.06.20262.1	Cumberland	3	SR-2297 / SOPHIA BILL RD	FROM NC 53 TO SR 2225		2	2WU	NO	NO	0.86	18	0	0.86	9,943	5,469
<b>TOTAL FOR MAP NO. 3</b>														<b>9,943</b>	<b>5,469</b>
2024CPT.06.20262.1	Cumberland	4	SR-2231 / COGDELL RD	FROM SR 2023 TO SR 2229		2	2WU	NO	NO	0.63	20	0	0.63	8,144	4,479
<b>TOTAL FOR MAP NO. 4</b>														<b>8,144</b>	<b>4,479</b>
2024CPT.06.20262.1	Cumberland	5	SR-2230 / HAIR RD	FROM SR 2023 TO SR 2229		2	2WU	NO	NO	0.67	18	0	0.67	7,736	4,255
<b>TOTAL FOR MAP NO. 5</b>														<b>7,736</b>	<b>4,255</b>
2024CPT.06.20262.1	Cumberland	6	SR-2229 / MATT HAIR RD	FROM BLADEN CO. LINE TO SR 2023		2	2WU	NO	NO	5.17	18	0	5.17	60,020	33,011
<b>TOTAL FOR MAP NO. 6</b>														<b>60,020</b>	<b>33,011</b>
2024CPT.06.20262.1	Cumberland	7	SR-2228 / JOHNSON RD	FROM SR 2023 TO NC 53		2	2WU	NO	NO	3.55	18	0	3.55	41,283	22,706
<b>TOTAL FOR MAP NO. 7</b>														<b>41,283</b>	<b>22,706</b>
2024CPT.06.20262.1	Cumberland	8	SR-2227 / MACK SIMMONS RD	FROM NC 53 TO SR 2226		2	2WU	NO	NO	0.98	18	0	0.98	11,360	6,248
<b>TOTAL FOR MAP NO. 8</b>														<b>11,360</b>	<b>6,248</b>
2024CPT.06.20262.1	Cumberland	9	SR-2226 / DUDLEY RD	FROM SR 2228 TO SR 2023		2	2WU	NO	NO	3.98	20	0	3.98	51,381	28,260
<b>TOTAL FOR MAP NO. 9</b>														<b>51,381</b>	<b>28,260</b>
2024CPT.06.20262.1	Cumberland	10	SR-2225 / MCKINNON RD	FROM NC 53 TO SR 2226		2	2WU	NO	NO	1.6	18	0	1.6	18,528	10,190
<b>TOTAL FOR MAP NO. 10</b>														<b>18,528</b>	<b>10,190</b>
<b>TOTAL FOR PROJ NO. 2024CPT.06.20262.1</b>														<b>222,405</b>	<b>122,323</b>
<b>GRAND TOTAL</b>														<b>222,405</b>	<b>122,323</b>

PROJECT NO.	SHEET NO.	TOTAL NO.
2024CPT.06.20262.1		

## THERMOPLASTIC AND PAINT QUANTITIES

PROJECT NO	COUNTY	MAP NO	ROUTE	DESCRIPTION	TYP NO	LANES	LANE TYPE	LENGTH	WIDTH	BEGIN MP	END MP	4413000000-E	4457000000-N
								MI	FT			WORK ZONE ADVANCE/GENERAL WARNING SIGNING	TEMPORARY TRAFFIC CONTROL
2024CPT.06.20262.1	Cumberland	1	SR-2045 / A B SMITH RD	FROM SR 1002 TO NC 53		2	2WU	0.86	20	0	0.86	112	1.00
<b>TOTAL FOR MAP NO. 1</b>								<b>0.86</b>				<b>112</b>	<b>1</b>
2024CPT.06.20262.1	Cumberland	2	SR-2373 / MILL CREEK RD	FROM SR 2023 TO DEAD END		2	2WU	0.26	18	0	0.26	112	
<b>TOTAL FOR MAP NO. 2</b>								<b>0.26</b>				<b>112</b>	
2024CPT.06.20262.1	Cumberland	3	SR-2297 / SOPHIA BILL RD	FROM NC 53 TO SR 2225		2	2WU	0.86	18	0	0.86	112	
<b>TOTAL FOR MAP NO. 3</b>								<b>0.86</b>				<b>112</b>	
2024CPT.06.20262.1	Cumberland	4	SR-2231 / COGDELL RD	FROM SR 2023 TO SR 2229		2	2WU	0.63	20	0	0.63	112	
<b>TOTAL FOR MAP NO. 4</b>								<b>0.63</b>				<b>112</b>	
2024CPT.06.20262.1	Cumberland	5	SR-2230 / HAIR RD	FROM SR 2023 TO SR 2229		2	2WU	0.67	18	0	0.67	112	
<b>TOTAL FOR MAP NO. 5</b>								<b>0.67</b>				<b>112</b>	
2024CPT.06.20262.1	Cumberland	6	SR-2229 / MATT HAIR RD	FROM BLADEN CO. LINE TO SR 2023		2	2WU	5.17	18	0	5.17	345	
<b>TOTAL FOR MAP NO. 6</b>								<b>5.17</b>				<b>345</b>	
2024CPT.06.20262.1	Cumberland	7	SR-2228 / JOHNSON RD	FROM SR 2023 TO NC 53		2	2WU	3.55	18	0	3.55	227	
<b>TOTAL FOR MAP NO. 7</b>								<b>3.55</b>				<b>227</b>	
2024CPT.06.20262.1	Cumberland	8	SR-2227 / MACK SIMMONS RD	FROM NC 53 TO SR 2226		2	2WU	0.98	18	0	0.98	112	
<b>TOTAL FOR MAP NO. 8</b>								<b>0.98</b>				<b>112</b>	
2024CPT.06.20262.1	Cumberland	9	SR-2226 / DUDLEY RD	FROM SR 2228 TO SR 2023		2	2WU	3.98	20	0	3.98	279	
<b>TOTAL FOR MAP NO. 9</b>								<b>3.98</b>				<b>279</b>	
2024CPT.06.20262.1	Cumberland	10	SR-2225 / MCKINNON RD	FROM NC 53 TO SR 2226		2	2WU	1.6	18	0	1.6	112	
<b>TOTAL FOR MAP NO. 10</b>								<b>1.6</b>				<b>112</b>	
<b>TOTAL FOR PROJ NO. 2024CPT.06.20262.1</b>								<b>18.56</b>		<b>0</b>	<b>18.56</b>	<b>1,635</b>	<b>1.000</b>
<b>GRAND TOTAL</b>								<b>18.56</b>		<b>0</b>	<b>18.56</b>	<b>1,635</b>	<b>1.000</b>